

CBLR2 Series Cable Retractors for FlipTops™

DO Prepare the FlipTop

Preparation of the Crestron® FlipTop™ consists of the following:

- Modifying the FlipTop assembly to accommodate the cable retractors
- Determining the desired mounting orientation (Retractors are shipped configured for vertical orientation, but are easily reconfigured for horizontal orientation.)

NOTE: The CBLR2-DP-V and CBLR2-DP-H models are dedicated to vertical and horizontal orientation, respectively.

NOTE: For preparation of the FlipTop 600 Series models, refer to “Modify the FlipTop (FlipTop 600 Series Models).”

Modify the FlipTop (Excludes FlipTop 600 Series Models)

1. Remove four screws (A) to detach the lower bar assembly. Also remove two screws (B). Retain screws A and B to attach the FlipTop mounting bracket assembly. Refer to the FlipTop mounting brackets table provided in the “DO Check the Accessories” section on the next page to ensure that the mounting bracket received is appropriate for the FlipTop being modified.
2. Remove four screws (C) to detach the cable guide. Retain the screws to attach the two side filler plates (sold separately).

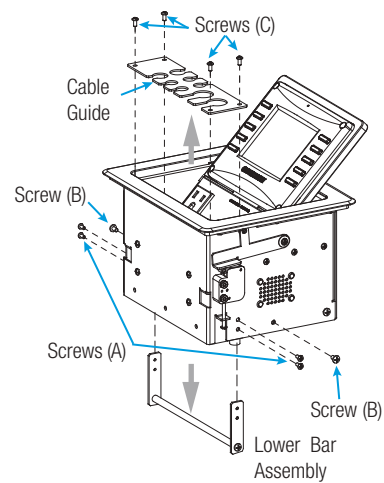

3. Move the mounting bracket assembly up into position and secure it using four screws (A) and two screws (B) removed in step 1.

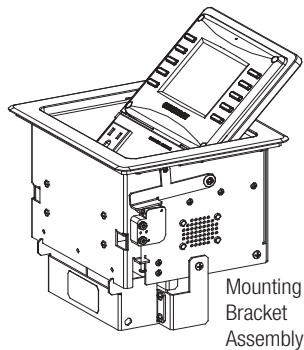
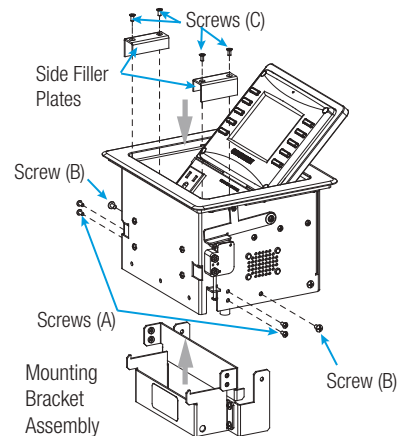

4. Position the side filler plates and secure them using four screws (C).

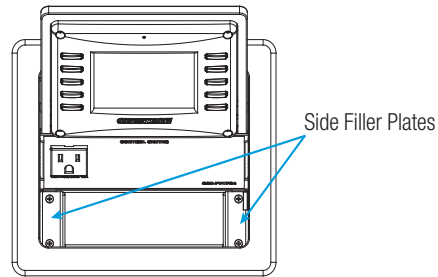

Modify the FlipTop (FlipTop 600 Series Models)

Retractors can be installed in both the left and right sides of the FlipTop 600 Series models.

1. Remove the screw (C) holding the cable guide in place, and then remove the cable guide.
2. Remove the screws (D) holding the cable pass-through bracket in place, and then remove the cable pass-through bracket.
3. Remove the shoulder screws from the front of the unit. Save these as they are used in retractor installation.

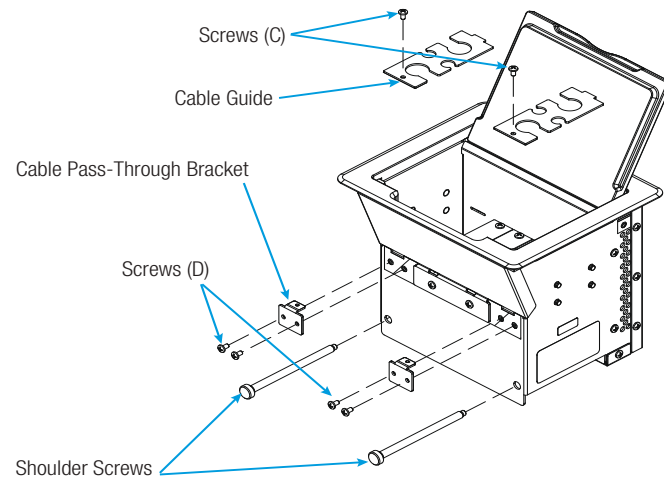

Reconfigure the Retractors for Horizontal Operation

NOTE: The CBLR2-DP-V and CBLR2-DP-H models are dedicated to vertical and horizontal orientation, respectively.

To reconfigure the retractors for horizontal orientation, refer to the following illustrations and perform these steps:

1. Remove the four screws (E), two from each side of the retractor, that attach the neck in the vertical orientation.

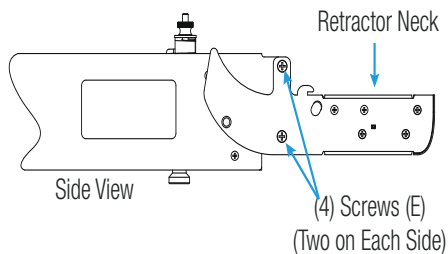

2. Reposition the neck as shown in the horizontal orientation view and attach it using the four screws (E) to secure the neck in that position.

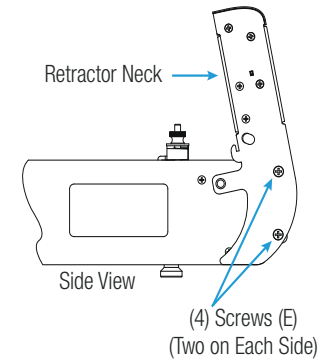

DO Adjust the Retractor

Once the retractor arm configuration is set, refer to the following illustration and adjust the retractor arm tension and cable retraction speed as follows:

1. Adjust the retractor tension by loosening the top thumb screw enough to enable pulling or pushing of the adjacent cable end. Align the red screw with the label arrow.
2. Adjust the cable retraction speed.
 - a. Pull the knob outward and move it to the VERT or HORZ position to match the configuration of the retractor arms.
 - b. Pull the cable (plug end) out so it is fully extended.
 - c. Pull the cable a second time to cause it to retract, and observe the speed of the cable retraction. If it is too slow or too fast, reposition the knob to an intermediate position and recheck.

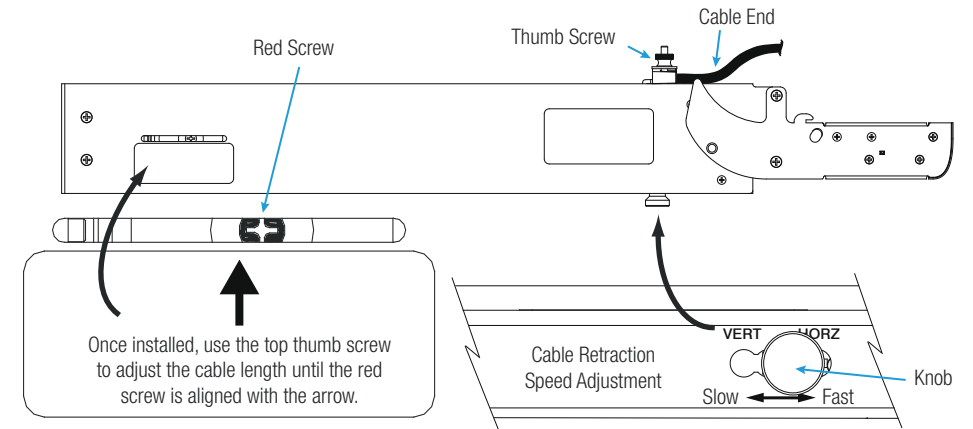

DO Attach the Retractors

The final assembly consists of attaching the cable retractors to the FlipTop box.
During the following procedures, refer to the accompanying illustrations.

Attach the Cable Retractors to the FlipTop (Excludes FlipTop 600 Series Models)

- 1. Insert the necks of the retractors and any included spacers up and into the mounting bracket assembly until they engage the frame of the assembly.
- 2. Carefully slide the clevis pin through the hole in the side of the mounting bracket assembly and then through each item being mounted until it protrudes through the opposite side of the assembly.
- 3. Insert the supplied hairpin cotter pin into the hole in the clevis pin.
- 4. Tighten the screws in the neck assemblies so they are just snug against the clevis pin.

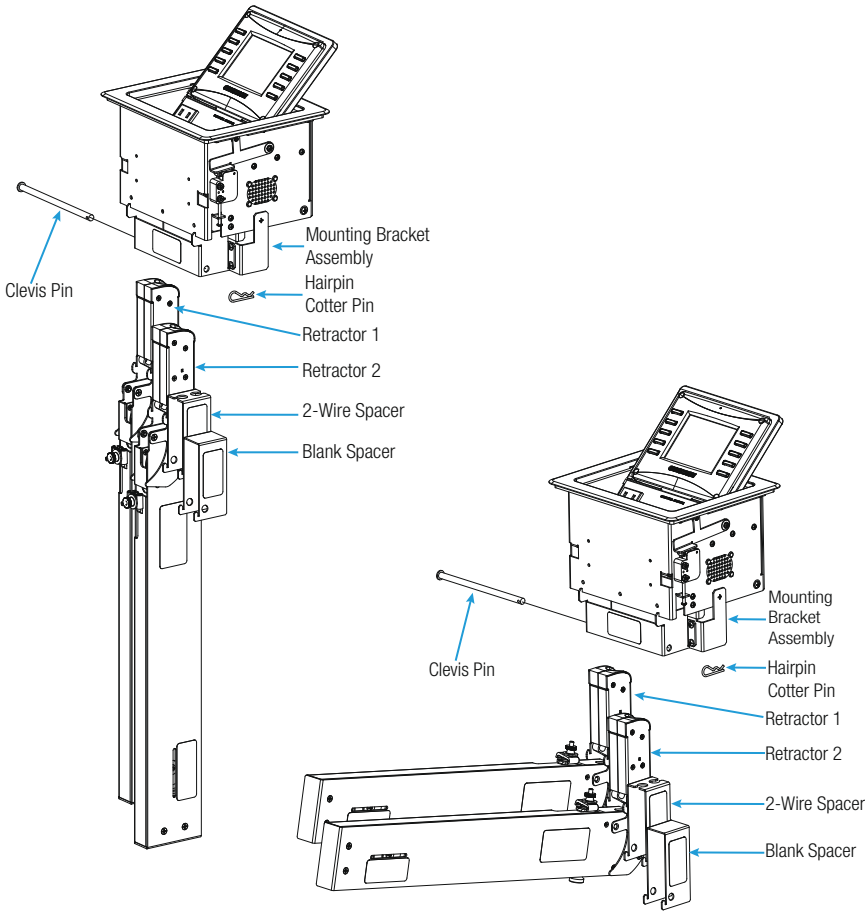

Attach the Cable Retractors to the FlipTop (FlipTop 600 Series Models)

- 1. Insert the necks of the retractors into the FlipTop until they engage the frame of the assembly.
- 2. Insert the shoulder screws into the front of the FlipTop.
- 3. Tighten each individual set screw on the retractors.

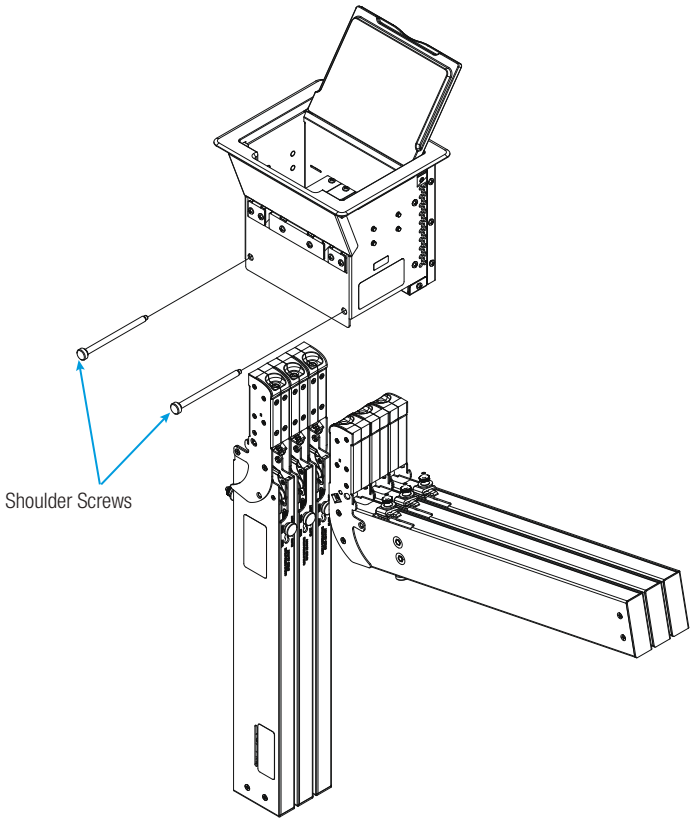

DO Check the Accessories

NOTE: The following excludes FlipTop 600 Series models.

	DOMESTIC MODELS		INTERNATIONAL MODELS
	(3-Position)	(4-Position)	(4-Position)
Mounting Bracket Assemblies	CBLRA-BRKT-3-FT 6506101	CBLRA-BRKT-4-FT 6506162	CBLRAI-BRKT-4-FT 6506188
Applicable FlipTop Models	FT-PWR-D	C2N-FTR-TPS4	FTI-PWR-D
	QM-FTCC	C2N-FTR-TPS4-U	QMI-FTCC
	QM-FTCC-NB	FT-PWR-D-LG	QMI-FTCSC
	QM-FTDC	QM-FTCC-TPS4	QMI-FTDC
	QM-FTDC-NB		QMI-FTMC
	QM-FTMC		

There are two spacer insert models, which can be used to fill unpopulated retractor slots:

- CBLRA-INSERT-BLANK, Part No. 6506163
- CBLRA-INSERT-2WIRE, Part No. 6506164

DO Learn More

Crestron Electronics 15 Volvo Drive, Rockleigh, NJ 07647
888.CRESTRON | www.crestron.com



CE As of the date of manufacture, the CBLR2 Series has been tested and found to comply with specifications for CE marking.

The specific patents that cover Crestron products are listed at [patents.crestron.com](https://www.crestron.com/patents). Product warranty can be found at www.crestron.com/warranty.
Crestron, the Crestron logo, FlipTop, and FlipTops are either trademarks or registered trademarks of Crestron Electronics, Inc. in the United States and/or other countries. Other trademarks, registered trademarks, and trade names may be used in this document to refer to either the entities claiming the marks and names or their products. Crestron disclaims any proprietary interest in the marks and names of others. Crestron is not responsible for errors in typography or photography.
This document was written by the Technical Publications department at Crestron.
©2014 Crestron Electronics, Inc.